

Valves

VKD Double union ball valves Manual – EPDM seals

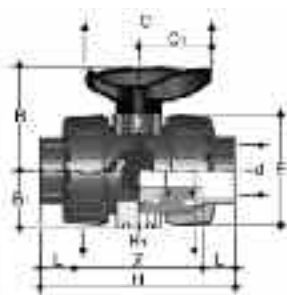

d	DN	PN	L	Z	H	E	B	C	gms	Code
3/8	10	16	14.5	74	103	55	49	66	195	H0 DKA 101
1/2	15	16	16.5	70	103	55	49	66	195	H0 DKA 102
3/4	20	16	19	77	115	66	59	75	315	H0 DKA 103
1	25	16	22.5	83	128	75	66	85	435	H0 DKA 104
1 1/4	32	16	26	94	146	87	75	97	655	H0 DKA 105
1 1/2	40	16	30	104	164	100	87	110	880	H0 DKA 106
2	50	16	36	127	199	122	101	134	1560	H0 DKA 107

Options:

FPM seals (plain ends) order H0 DKB***

FPM seals (threaded ends) order H0 DKB***

Manual valves can be supplied with locking kits - further information is available from our Valve Department.

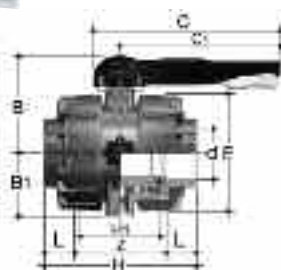

d	DN	PN	Z	L	H	H ₁	E	B	B ₁	C	C ₁	gms	Code
2 1/2	65	16	147	44	235	133	164	164	87	225	175	4380	H0 DKA 108
3	80	16	168	51	270	149	203	177	105	327	272	7200	H0 DKA 109
4	100	16	186	61	308	167	238	195	129	385	330	11141	H0 DKA 110

Options:

FPM seals (plain ends) order H0 DKB***

TKD 3-way ball valves Manual – EPDM seals

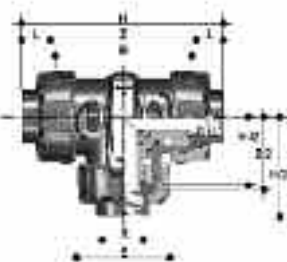
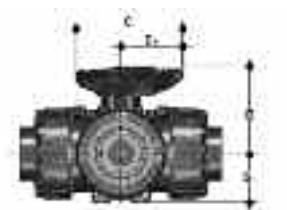

T port design

d	DN	PN	H	Z	C	C ₁	B	B ₁	gms	Code
1/2	15	16	125	95	67	40	54	29	310	H0 TTA 102
3/4	20	16	146	114	85	49	65	34.5	550	H0 TTA 103
1	25	16	166	129	85	49	65.9	39	790	H0 TTA 104
1 1/4	32	16	195.5	151	108	64	82.5	46	1275	H0 TTA 105
1 1/2	40	16	211	166	108	64	89	52	1660	H0 TTA 106
2	50	16	253.5	199	134	76	108	62	2800	H0 TTA 107

Options:

FPM seals (plain ends) order H0 TTB***

FPM seals (threaded ends) order H0 TTB***

Manual valves can be supplied with locking kits - further information is available from our Valve Department.

L port design

d	DN	PN	H	Z	C	C ₁	B	B ₁	gms	Code
1/2	15	16	125	95	67	40	54	29	310	H0 LTA 102
3/4	20	16	146	114	85	49	65	34.5	550	H0 LTA 103
1	25	16	166	129	85	49	65.9	39	790	H0 LTA 104
1 1/4	32	16	195.5	151	108	64	82.5	46	1275	H0 LTA 105
2	50	16	253.5	199	134	76	108	62	2800	H0 LTA 107

Options:

FPM seals (plain ends) order H0 LTB***

VKD & TKD ball valves can be supplied electrically or pneumatically actuated.

EV Double union ball valves Manual – EPDM seals

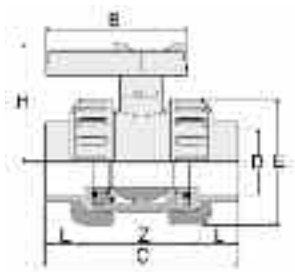

d	DN	PN	L	Z	C	E	H	B	gms	Code	
										Plain	Threaded
1/2	15	10	17	47	81	50	50	57	95	HO EVA 102	HO EVA B02
3/4	20	10	19	51	95	59	55	66	156	HO EVA 103	HO EVA B03
1	25	10	22	61	105	68	66.5	75	228	HO EVA 104	HO EVA B04
1 1/4	32	10	31	84	146	96	93	103	540	HO EVA 105	HO EVA B05
1 1/2	40	10	31	84	146	96	93	103	540	HO EVA 106	HO EVA B06
2	50	10	38	96	172	116	107	121	844	HO EVA 107	HO EVA B07

UC Ball check valves Plain ends – EPDM seals (other options available)

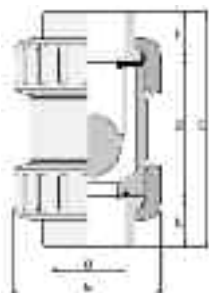

Size	L	Z	C	E	gms	Code
1/2	17	48	82	50	96	HO UCA 102
3/4	19	55	93	59	99	HO UCA 103
1	22	62	106	68	145	HO UCA 104
1 1/4	26	75	127	80	234	HO UCA 105
1 1/2	31	84	146	96	357	HO UCA 106
2	38	99	175	116	937	HO UCA 107

Options:

EPDM seals (threaded ends) order HO UCA B**

FPM seals (plain ends) order HO UCB***

FPM seals (threaded ends) order HO UCB B**

Note: this valve must be installed at a minimum distance of 10 x nominal diameter (eg. 20" for size 2") from pump flange.

UA Air release valves Plain ends – EPDM seals (other options available)

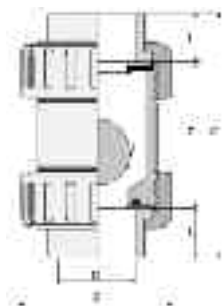

Size	L	Z	C	E	gms	Code
1/2	17	48	82	50	96	HO UAA 102
3/4	19	55	93	59	99	HO UAA 103
1	22	62	106	68	145	HO UAA 104
1 1/4	26	75	127	80	234	HO UAA 105
1 1/2	31	84	146	96	357	HO UAA 106
2	38	99	175	116	937	HO UAA 107

Options:

EPDM seals (threaded ends) order HO UAA B**

FPM seals (plain ends) order HO UAB***

FPM seals (threaded ends) order HO UAB B**

RV Y-Type strainers Plain ends – EPDM seals

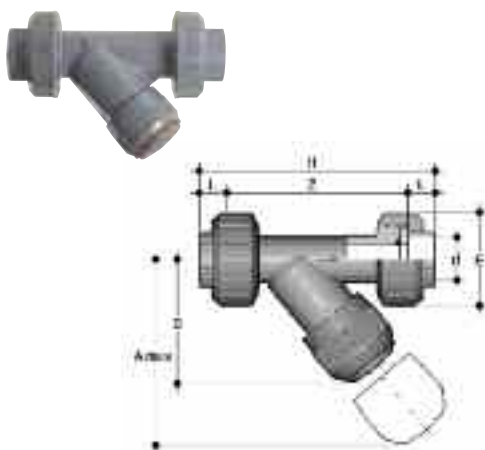

d	DN	PN	A	B	E	L	Z	H	Fig.	gms	Code
			Grey	max							
1/2	15	15	125	72	55	16	103	135	A	162	HO UVA 102
3/4	20	15	145	84	66	19	120	158	A	274	HO UVA 103
1	25	15	165	95	75	22	132	176	A	403	HO UVA 104
1 1/4	32	15	190	111	87	26	155	207	A	562	HO UVA 105
1 1/2	40	15	210	120	100	31	181	243	A	839	HO UVA 106
2	50	9	240	139	120	38	222	298	A	1413	HO UVA 107

Options:

EPDM seals (threaded ends) order HO RVA B**

FPM seals (plain ends) order HO RVB***

FPM seals (threaded ends) order HO RVB B**

VM Diaphragm valves Manual – plain union ends – EPDM seals

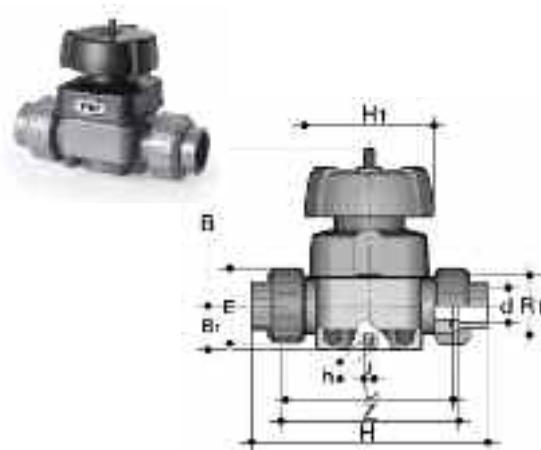

d	DN	PN	B	B ₁	H	h	H ₁	J	L	gms	Code
1/2	15	10	95	26	124	12	90	M6	16	700	HO UMA 102
3/4	20	10	95	26	144	12	90	M6	19	700	HO UMA 103
1	25	10	95	26	154	12	90	M6	23	700	HO UMA 104
1 1/4	32	10	126	40	174	18	115	M8	27	1500	HO UMA 105
1 1/2	40	10	126	40	194	18	115	M8	32	1500	HO UMA 106
2	50	10	148	40	224	18	140	M8	39	2400	HO UMA 107
* 2 1/2	65	10	225	55	284	23	215	M12	44	7000	HO VMA 208
* 3	80	10	225	55	300	23	215	M12	51	7000	HO VMA 209
* 4	100	10	295	69	350	23	250	M12	-	10500	HO VMA 210

Options:

FPM diaphragm order HO VMB***

PTFE diaphragm order HO VMC***

Manual valves can be supplied with locking kits - further information is available from our Valve Department.

*Note: 2 1/2", 3" and 4" are spigot ended.

PR Pressure relief valves EPDM seals

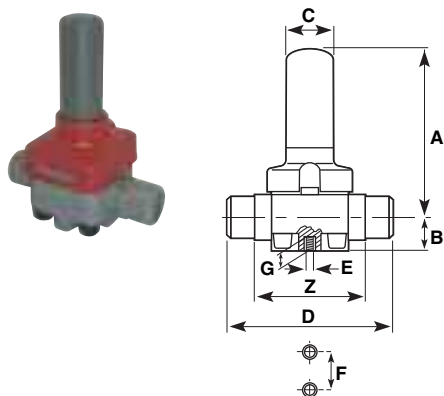

Size	PN	Z	A	B	C	D	E	F	G	gms	Code
1/2	10	92	143	20.5	35	124	M6	25	12	700	HO PRA 202
3/4	10	106	143	20.5	35	144	M6	25	12	700	HO PRA 203
1	10	108	143	25.0	35	154	M6	25	12	700	HO PRA 204
1 1/4	10	120	204	36.0	50	174	M8	44.5	16	1500	HO PRA 205
1 1/2	10	130	204	39.5	50	194	M8	44.5	16	1500	HO PRA 206
2	10	146	219	49.0	50	224	M8	44.5	16	2400	HO PRA 207

Options:

FPM seals order HO PRB***

FK Butterfly valves Glass reinforced polypropylene with ABS disc and EPDM seals



lever operated

Size	DN	PN	B ₂	B ₃	C	C ₁	Z	gms	U	Code
1 1/2	40	16	60	137	175	100	33	900	4	HO FKA 106
2	50	16	70	143	175	100	43	1080	4	HO FKA 107
2 1/2	65	10	80	164	272	110	46	1470	4	HO FKA 108
3	80	10	93	178	272	110	49	1870	8	HO FKA 109
4	100	10	107	192	272	110	56	2220	8	HO FKA 110
5	125	10	120	212	330	110	64	3100	8	HO FKA 111
6	150	10	134	225	330	110	70	3850	8	HO FKA 112
8	200	10	161	272	420	122	71	6750	8	HO FKA 113

Options:

FPM seals order HO FKB***

U = No. of holes

with gear box

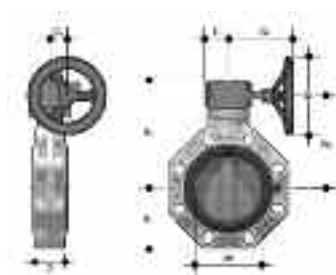

Size	DN	PN	B ₂	B ₅	B ₆	G	G ₁	G ₂	G ₃	Z	gms	U	Code
2 1/2	65	10	80	174	146	48	135	39	125	46	2400	4	HV FKA 108
3	80	10	93	188	160	48	135	39	125	49	2800	8	HV FKA 109
4	100	10	107	202	174	48	135	39	125	56	3150	8	HV FKA 110
5	125	10	120	222	194	48	144	39	200	64	4450	8	HV FKA 111
6	150	10	134	235	207	48	144	39	200	70	5200	8	HV FKA 112
8	200	10	161	287	256	65	204	60	200	71	9300	8	HV FKA 113
10	250	10	210	317	281	88	236	76	250	114	18600	12	HV FKA 114
12	300	8	245	374	338	88	236	76	250	114	25600	12	HV FKA 115

Options:

FPM seals order HV FKB***

U = No. of holes

Note: Lugged versions available to special order. Please refer to our Valve Department for further details.

Valves can be supplied as electrically or pneumatically actuated. For further details contact our Valve department on 01543 272424.